

DRAWING LOCATION		C-2A-514	
DATE	BY	WAS	BY
1/14/50	FOR	ORIG. USE	5-2375-20

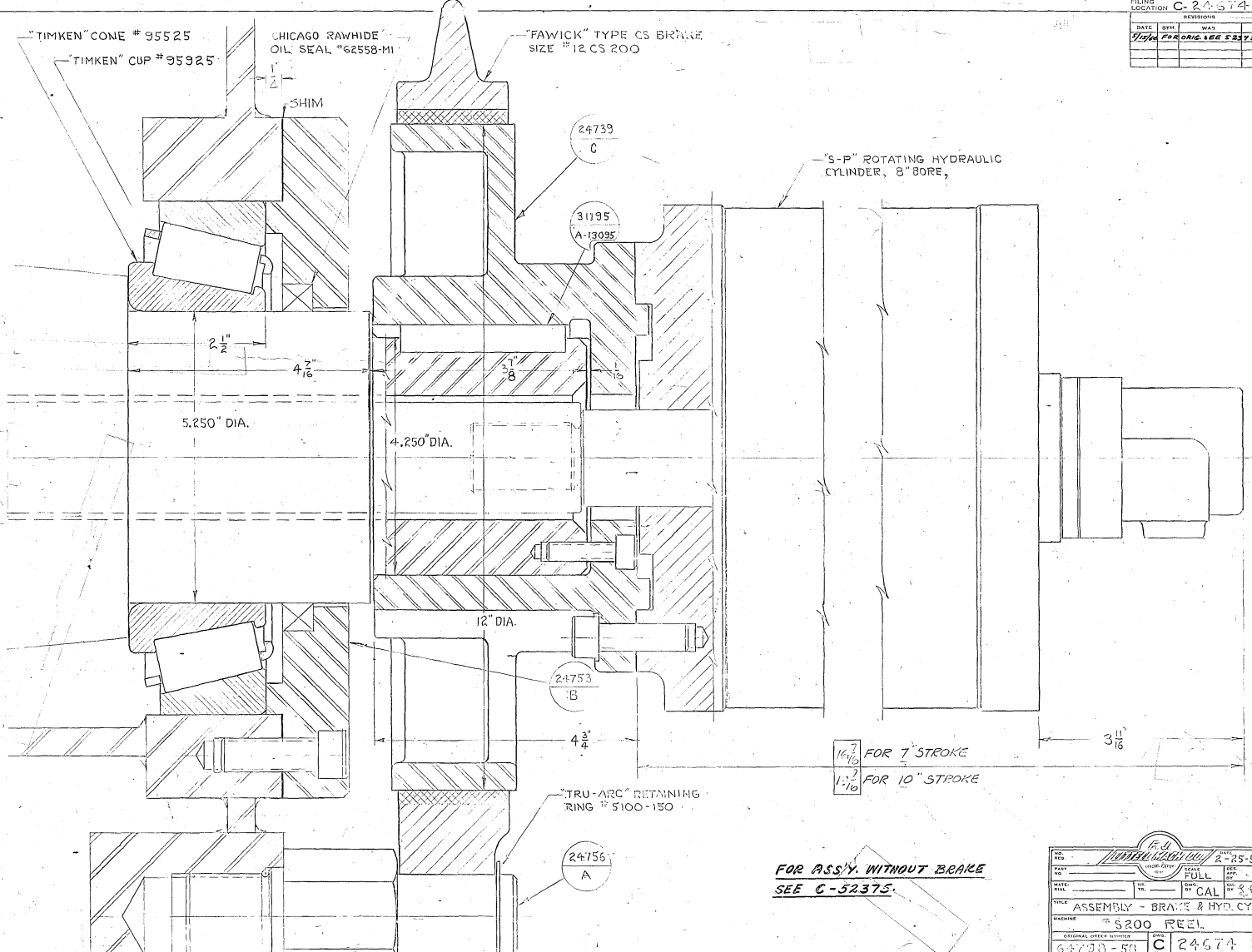

1 1/16" FOR 7" STROKE
 1 1/16" FOR 10" STROKE

**FOR ASS'Y. WITHOUT BRAKE
 SEE C-52375.**

REV.	DATE	BY	APP.
	2-25-50		
GENERAL ELECTRIC DIVISION OF WESTINGHOUSE		TITLE ASSEMBLY - BRAKE & HYD. CYL.	DRAWING NO. 24674
MACHINE 5200 REEL	ORIGINAL ORDER NUMBER 64730-50	C SEE	DATE 2-25-50