

**PARTS LIST AND OPERATING INSTRUCTIONS
FOR
NUMBER 25 AND NUMBER 40 SINGLE AUTOMATIC
CENTERING REEL WITH ELECTRIC BRAKE**

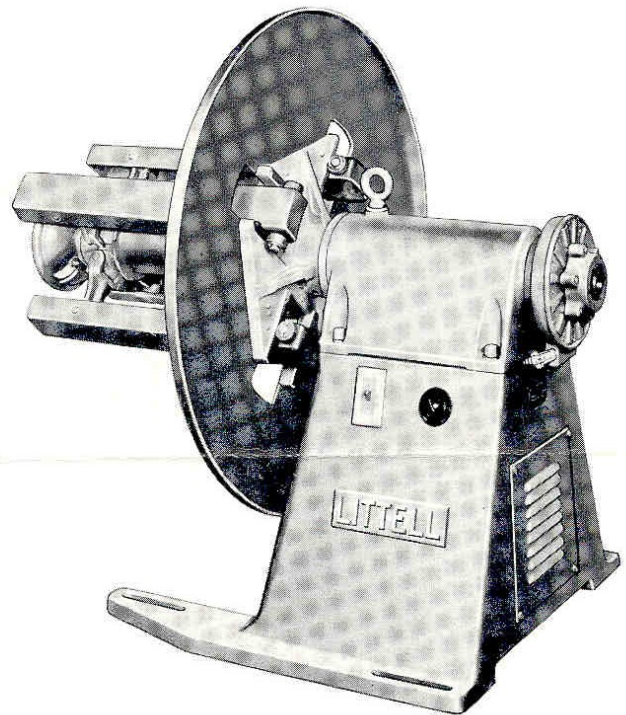
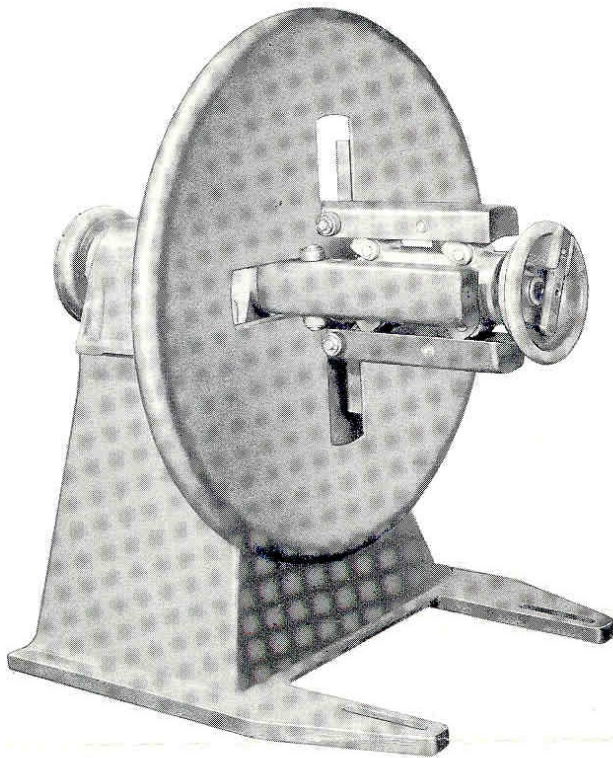

CAPACITIES

SIZE OF REEL	25-12	25-18	25-24	25-36	40-18	40-24	40-36
MAX WEIGHT OF COIL	2500 lbs	2500 lbs	2500 lbs	1500 lbs	4000 lbs	4000 lbs	3000 lbs
INSIDE DIA.	12"-15" or 15"-20"	12"-15" or 15"-20"	12"-15" or 15"-20"	12"-15" or 15"-20"	15"-18" or 16"-22"	15"-18" or 16"-22"	15"-18" or 16"-22"
MAX OUTSIDE DIA.	40"	40"	40"	40"	45"	45"	45"
MAX WIDTH	12"	18"	24"	36"	18"	24"	36"

F. J. LITTELL MACHINE CO.

4101 N. RAVENSWOOD AVENUE

CHICAGO 13, ILLINOIS



No. 25 AND No. 40 SINGLE AUTOMATIC CENTERING REEL WITH ELECTRIC BRAKE

IMPORTANT

When ordering repair parts, specify part number plus serial number, code number and size of machine. Send all repair parts orders to the Chicago factory.

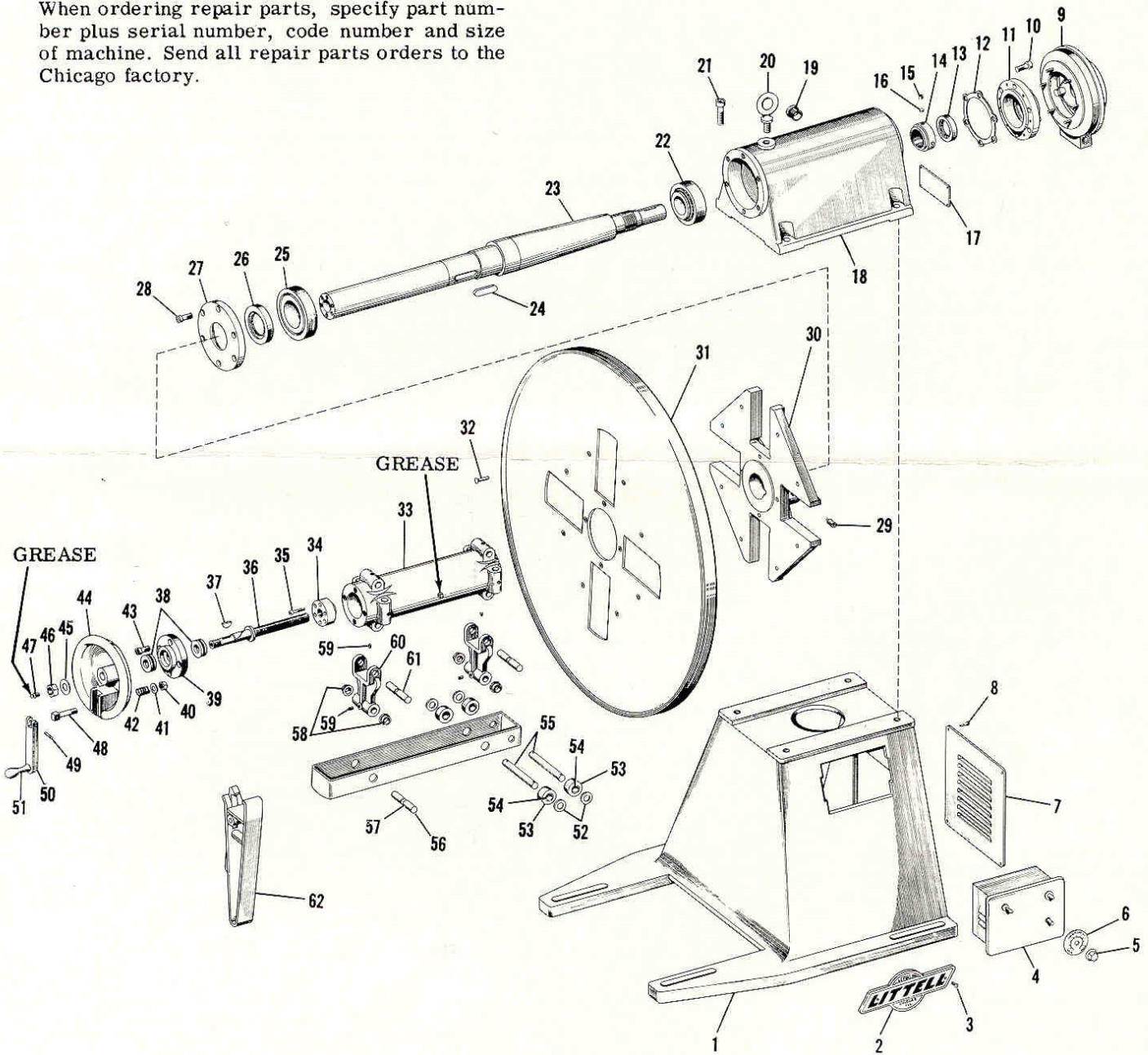

**No. 25 AND No. 40 SINGLE AUTOMATIC CENTERING REEL WITH
ELECTRIC BRAKE**



PARTS LIST

INDEX NO.	DESCRIPTION	PART NUMBER	
		#25-18 REEL	#40-18 REEL
1	Base	25RS-069	40RS-086
2	Name Plate	4FS-71	4FS-71
3	Self Tapping Flat Hd. Screw (Phillips)	1/4 x 3/4"	1/4 x 3/4"
4	Rheostat Knob (Ohmite)	#5150	#5150
5	Rheostat Dial Plate	40RS-087	40RS-087
6	D. C. Power Pack	13623	13623
7	Louvre Plate	4FS-0311	4FS-0311
8	Rd. Hd. Machine Screw	1/4-20 x 1/2"	1/4-20 x 1/2"
9	Electric Brake Unit (Warner)	#1000	#1000
10	Hol. Hd. Cap Screw	1/2-13 x 1-1/4"	1/2-13 x 1-1/4"
11	Rear Bearing Retainer	40RS-34	40RS-34
12	Shim Set (Timken)	#19	#19
13	Oil Seal (Chicago Rawhide)	#3002	#3002
14	Bearing Lock Nut	40RS-0115	40RS-0115
15	Socket Set Screw	1/4-20 x 1/2"	1/4-20 x 1/2"
16	Brass Button, 1/4"	ORS-050	ORS-050
17	Name Plate	40RS-039	40RS-039
18	Bearing Case	25RS-21	25RS-21
19	Oil Gauge Plug (Gits style "BW")	#4043	#4043
20	Eye Bolt (Williams "Vulcan" #28 Shlder.)	25RS-073	25RS-073
21	Hol. Hd. Cap Screw	3/4-10 x 2"	3/4-10 x 2"
22	Roller Bearing (Timken)	#623-612	#623-612
23	Spindle Shaft*	25RS-090	40RS-0111
24	Disc Hub Key	25RS-034	40RS-084
25	Roller Bearing (Timken)	#661-652	#594-592A
26	Oil Seal (Chicago Rawhide)	#42534	#475324
27	Front Bearing Retainer	25RS-3	25RS-3-S
28	Hol. Hd. Cap Screw	3/8-16 x 1-1/8"	1/2-13 x 1-1/2"
29	Dog Point Set Screw	5/8-11 x 1-1/8"	3/4-10 x 1-1/4"
30	Disc Hub	25RS-10	40RS-30
31	Guide Plate	25RS-021	40RS-081

INDEX NO.	DESCRIPTION	PART NUMBER	
		#25-18 REEL	#40-18 REEL
32	Flat Head Bolt & Lock Nut	3/8 x 1-1/2"	3/8 x 1-1/2"
33	Spindle*	25RS-6	40RS-29
34	Adjusting Screw Nut	25RS-7	40RS-11
35	Hol. Hd. Cap Screw	3/8-16 x 1-1/8"	1/2-13 x 1-1/2"
36	Adjusting Screw*	25RS-014	40RS-016
37	Key (Woodruff)	#91	#15
38	Thrust Bearing (Aetna)	#E9	#G19
39	Spindle End Cap	25RS-9	40RS-6
40	Elastic Stop Nut	1/2"-20 R. H.	1/2"-20 R. H.
41	Washer	17/32" I. D.	17/32" I. D.
42	Spring	5RF-0612	5RF-0612
43	Hol. Hd. Cap Screw	1/2-13 x 1"	1/2-13 x 1"
44	Hand Wheel	25RS-8	40RS-27
45	Washer	SW-14-36-3	SW-20-36-3
46	Hex. Nut	7/8"-14 R. H.	1-1/4"-12 R. H.
47	Grease Fitting (Alemite)	#1610 1/8" I. P. S.	#1610 1/8" I. P. S.
48	Handle Spring Pin	25RS-016	25RS-016
49	Handle Hinge Pin	25RS-017	25RS-017
50	Handle Bar	25RS-015	40RS-062
51	Handle (Cinn. "QA")	#3	#4
52	Roller Washer (Quadriga)	25RS-020	40RS-067
53	Roller	25RS-018	25RS-018
54	Bushing (Oilite)	#A-1049-1	#A-1008-13
55	Roller Pin	25RS-019	40RS-066
56	Arm Link Pin	25RS-022	40RS-064
57	Arm*	25RS-02	40RS-068
58	Bushing (Super, Oilite)	25RS-056	#A-1008-5
59	Socket Set Screw	3/8 x 1/2"	3/8 x 1/2"
60	Link †	25RS-11	40RS-28
61	Spindle Link Pin	25RS-022	40RS-065
62	Keeper Assembly (Consisting of the following parts) Keeper Keeper Catch Spring Plunger Spring (Danly) Dowel Pin Dowel Pin	25RS-77 25RS-051 25RS-052 25RS-053 25RS-054 3/8 x 2" 5/16 x 1"	25RS-77 25RS-051 25RS-052 25RS-053 25RS-054 3/8 x 2" 5/16 x 1"

*Specify whether for 12", 18", 24" or 36" wide Reel.
†Specify I. D. Required.



No. 25 AND No. 40 SINGLE AUTOMATIC CENTERING REEL WITH ELECTRIC BRAKE

OPERATING INSTRUCTIONS

A. ELECTRICAL CONNECTION. Connect the reel to the correct electrical voltage.

CAUTION

Be sure power source is correct for reel by checking voltage requirement on brake reel nameplate.

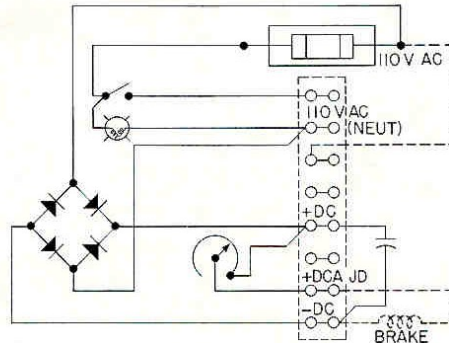

**WIRING
DIAGRAM**



B. REMOVE KEEPERS. Release keeper catch and slide keepers (62) from arms.

C. COLLAPSE ARMS.

- (1) Turn crank handle (51) in a counterclockwise direction to collapse arms so that they are at least 1 or 2 inches smaller than the inside diameter of the coil to be loaded.
- (2) Fold handle (51) in to prevent breakage.

D. LOAD COIL.

- (1) Load coil using a coil loading hook. Suspend hook from a hoist and insert in coil.
- (2) Raise coil to proper height.
- (3) Slide coil onto the arms and remove hook.

E. ATTACH KEEPERS. Slide keepers (62) into position on the arms (57) so that the coil is tight against the guide plate (31).

F. EXPAND ARMS.

- (1) Unfold crank.
- (2) Turn hand crank in a clockwise direction until the arms are fully extended against the coil.
- (3) Fold handle in to prevent breakage.

G. ADJUST BRAKE TENSION. Adjust the rheostat to obtain the desired amount of drag.

H. EMERGENCY STOPS. Wire the electric brake into the stop button of the production line. In doing so, full brake will automatically be applied when the balance of line is shut down.

MAINTENANCE INSTRUCTIONS

All Littell Reels are of very rigid construction and, if the capacities are not exceeded, will give years of trouble free service. Proper lubrication is the only maintenance required. Apply grease to grease fittings on spindle and on end of hand wheel.

GEAR CASE OIL. Medium heavy oil SAE 40 should be used in gear case. Remove eyebolt and fill case to bring oil level up to the middle of sight gage.

F. J. LITTELL MACHINE CO.

4101 N. RAVENSWOOD AVENUE

CHICAGO 13, ILLINOIS