

SECTION VII

ROLLER STOCK GUIDE

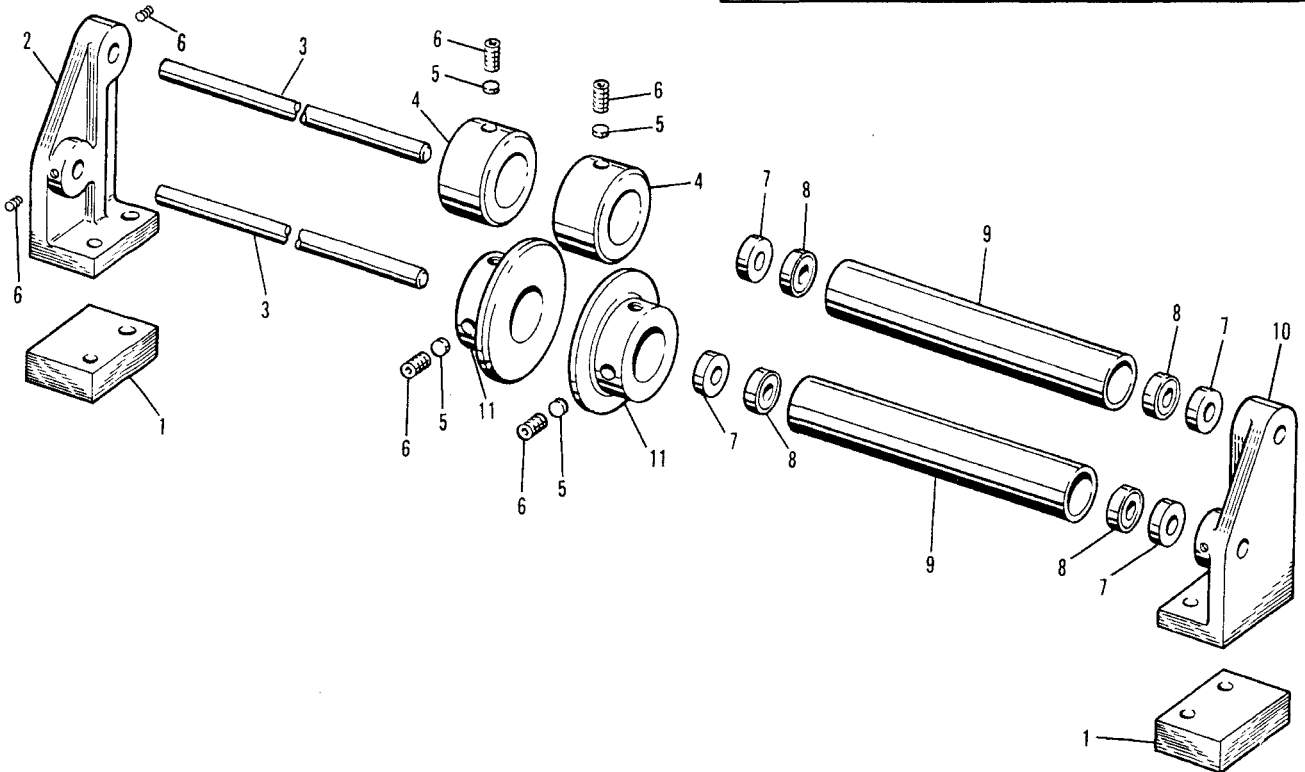

This Stock Guide Assembly is used on the medium duty feeding and straightening machines. In setting up this guide, the stock guide #11, should maintain at least 1/32" over the width of the stock so as to allow free passage of the stock through the guides. If the stock binds at this point, it can produce short feed lengths in the die area.



INDEX NO.	DESCRIPTION
1	Spacer - Stock Guide
2	Bracket - Guide Roll, Left-hand
3	Shaft - Guide Roll
4	Collar - Guide Roll
5	Button - Brass
6	Screw - Socket-head, Set
7	Collar - Shaft
8	Bearing - Ball
9	Roll - Guide
10	Bracket - Guide Roll, Right-hand
11	Guide - Stock